

31 January 2011

Dear Councillor

DEVELOPMENT CONTROL COMMITTEE - TUESDAY, 8TH FEBRUARY 2011

Please find enclosed location and layout plans for the planning applications that are to be considered at the above meeting of the Development Control Committee.

Agenda No	Item
4 a)	<u>09/01021/FULMAJ - Bank Hall, Bank Hall Drive, Bretherton</u> (Pages 1 - 6)
4 b)	<u>09/01022/LBC - Bank Hall, Bank Hall Drive, Bretherton</u> (Pages 7 - 12)
4 c)	<u>10/00176/OUTMAJ - Flat Iron Car Park, Union Street, Chorley</u> (Pages 13 - 16)
4 d)	<u>10/00771/FUL - Land immediately East of 43-51 of Acresfield, Adlington, Lancashire</u> (Pages 17 - 18)
4 e)	<u>10/00946/REMAJ - Vertex Training and Conference Centre Little Carr Lane, Chorley, PR7 3JT</u> (Pages 19 - 22)
4 f)	<u>10/01067/FULMAJ - Unicorn Fairs South Hall, Park Hall, Park Hall Road, Charnock Richard</u> (Pages 23 - 24)
4 g)	<u>10/01095/FUL - Sultan's Palace Indian Restaurant, Bolton Road, Anderton, Bolton</u> (Pages 25 - 28)
4 h)	<u>10/01012/FULMAJ - Parcel J and L Buckshaw Avenue, Buckshaw Village</u> (Pages 29 - 30)

Yours sincerely

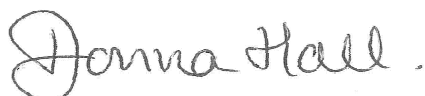

Donna Hall CBE
Chief Executive

E-mail: cathryn.barrett@chorley.gov.uk
Tel: (01257) 515123
Fax: (01257) 515150

Distribution

1. Agenda and reports to all Members of the Development Control Committee.

This information can be made available to you in larger print or on audio tape, or translated into your own language. Please telephone 01257 515118 to access this service.

આ માહિતીનો અનુવાદ આપની પોતાની ભાષામાં કરી શકાય છે. આ સેવા સરળતાથી મેળવવા માટે કૃપા કરી, આ નંબર પર ફોન કરો: 01257 515822

ان معلومات کا ترجمہ آپکی اپنی زبان میں بھی کیا جاسکتا ہے۔ یہ خدمت استعمال کرنے کیلئے براہ مہربانی اس نمبر پر ٹیلیفون

01257 515823

کیجئے:

02/04/2010
02/10/22

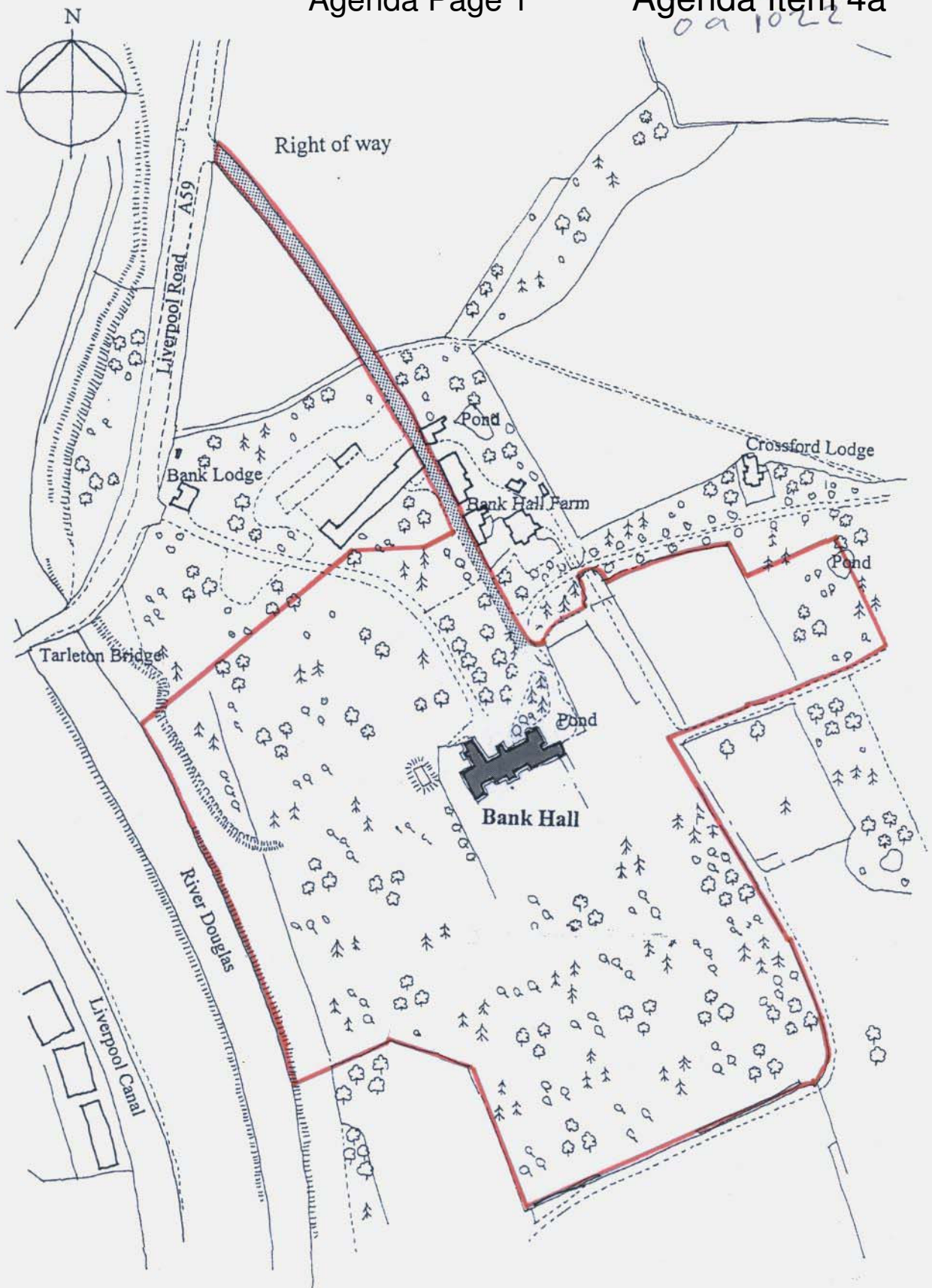

SITE PLAN

BANK HALL

0 10 20 30 40 50 100 Metres



18 DEC 2009



This page is intentionally left blank

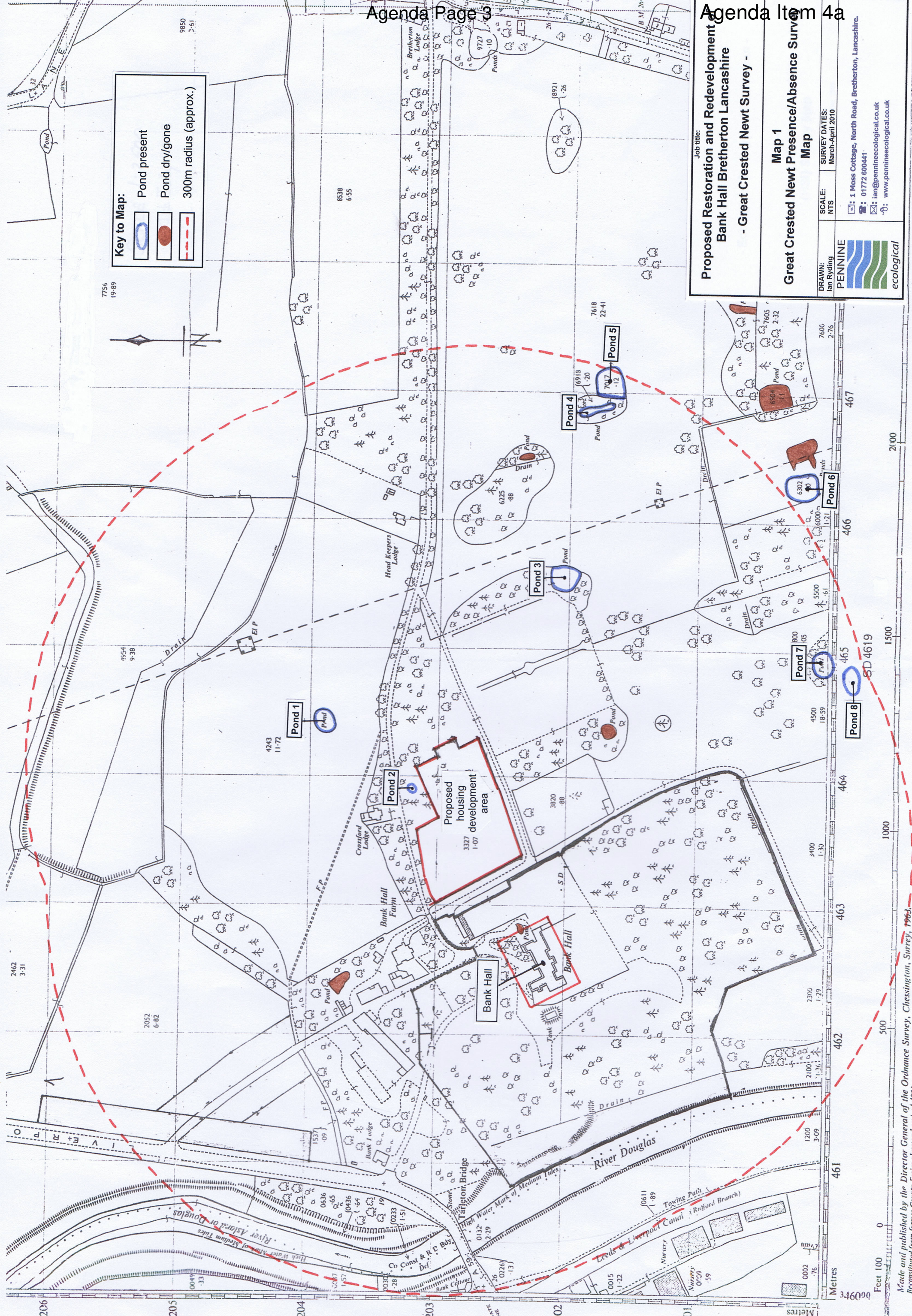

Proposed Restoration and Redevelopment of Bank Hall Bretherton Lancashire - Great Crested Newt Survey -

Map 1
Great Crested Newt Presence/Absence Survey Map

Job title:
DRAWN: Ian Ryding
SCALE: NTS
SURVEY DATES: March-April 2010

PENNINE ecological

1 Moss Cottage, North Road, Bretherton, Lancashire.
01772 600441
ian@pennineecological.co.uk
www.pennineecological.co.uk

This page is intentionally left blank

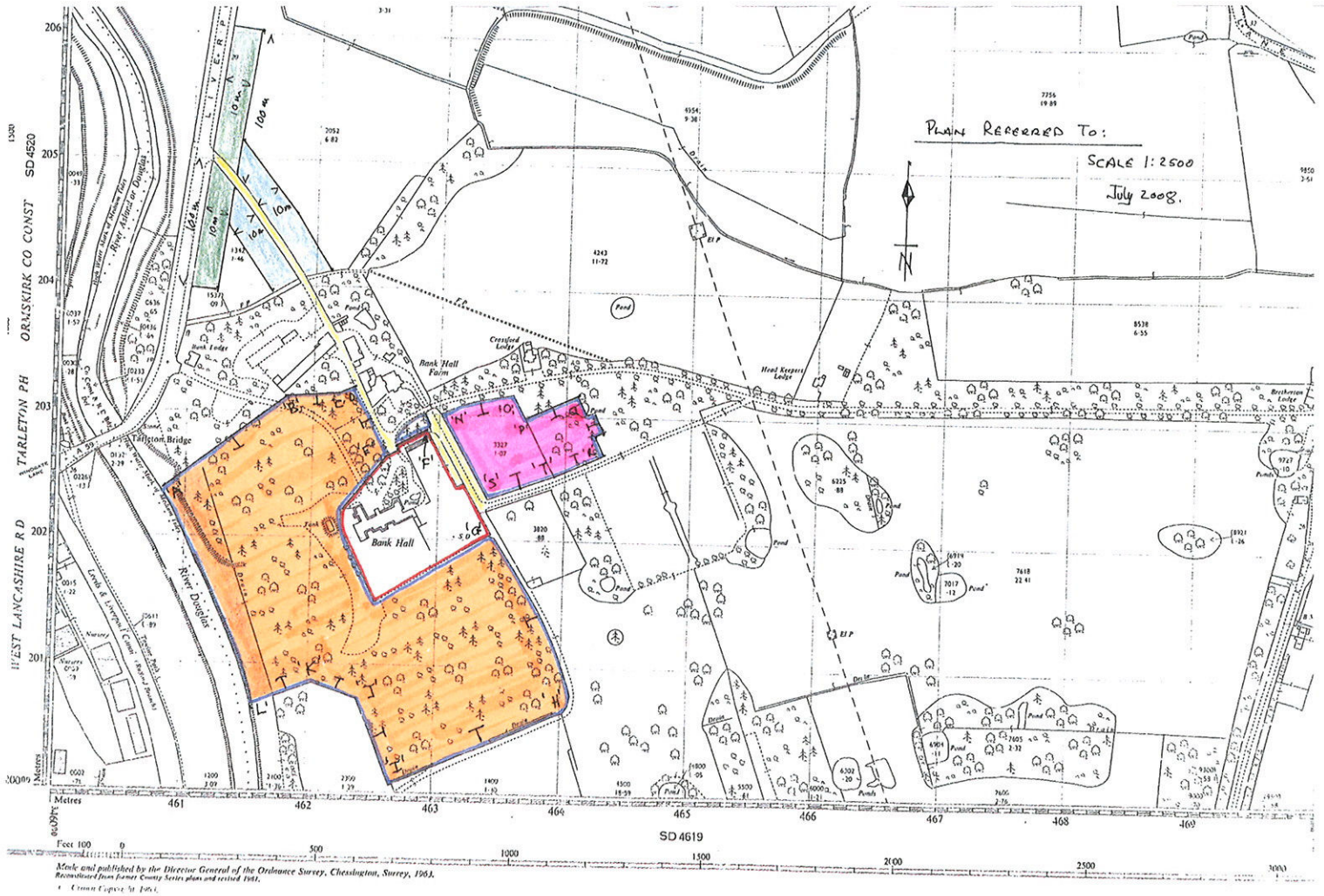

This page is intentionally left blank

02/04/2010
02/10/22

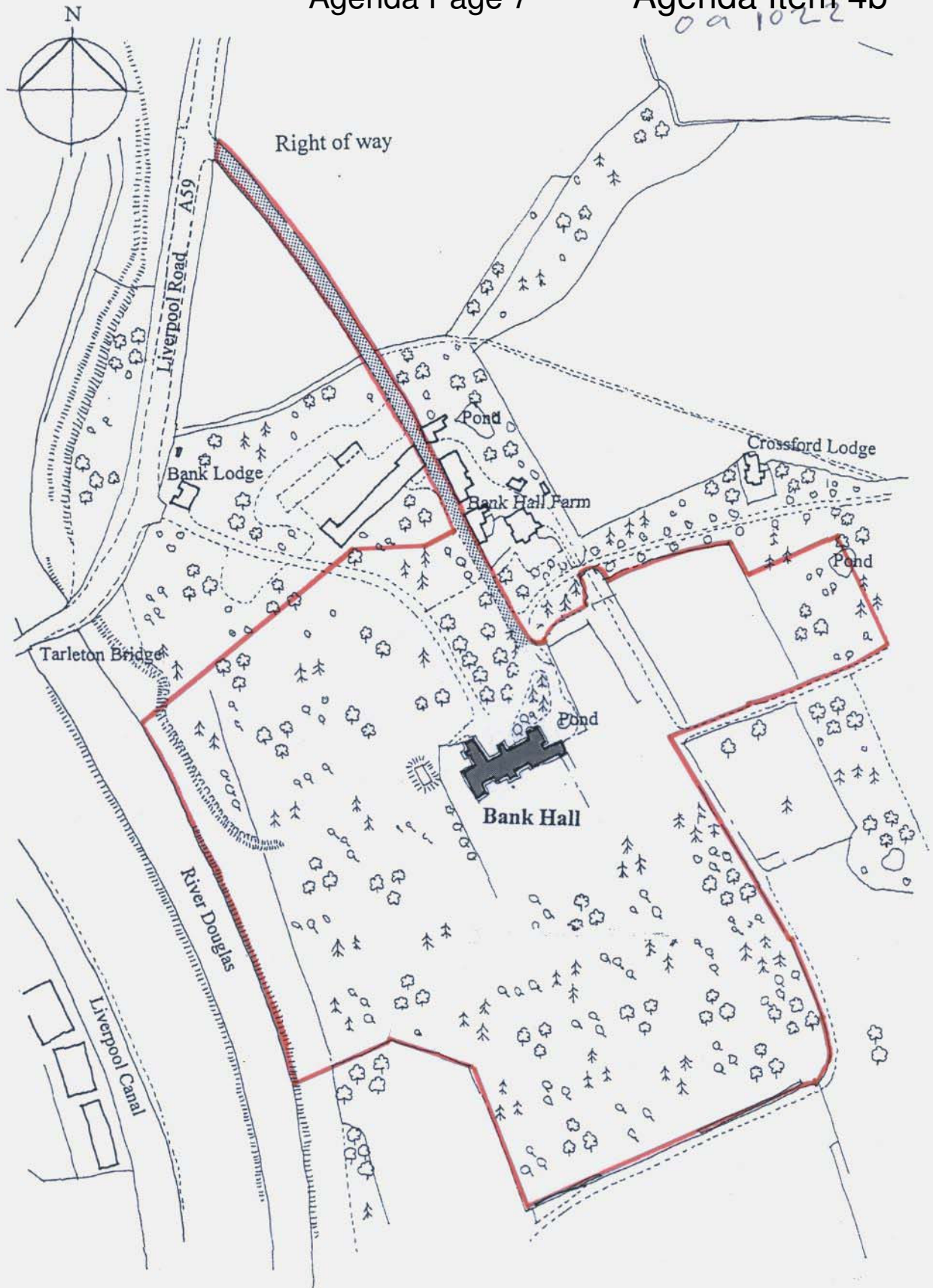

SITE PLAN

BANK HALL

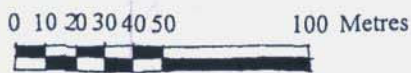

18 DEC 2009



This page is intentionally left blank

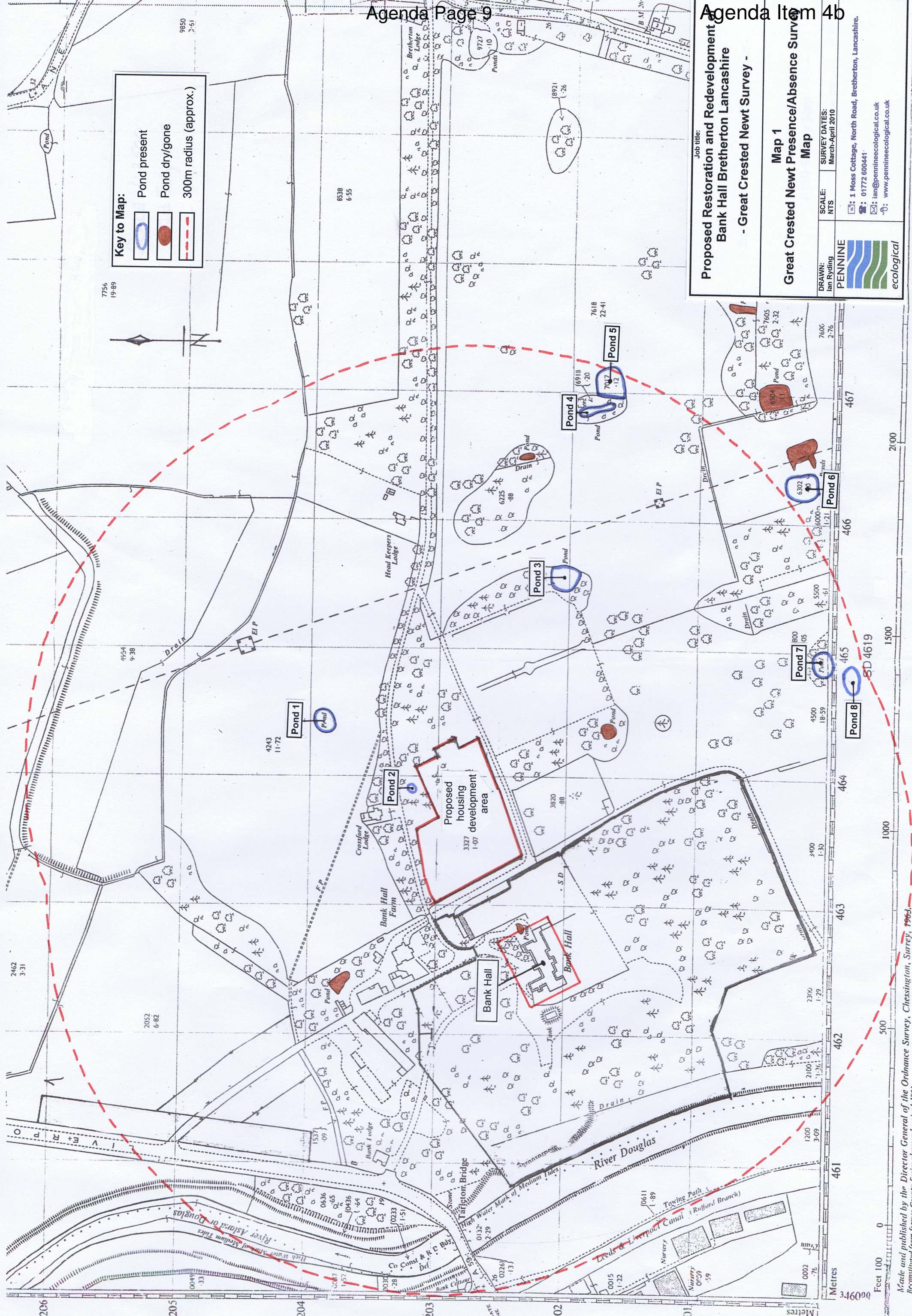

Proposed Restoration and Redevelopment of Bank Hall Bretherton Lancashire - Great Crested Newt Survey -

Map 1
Great Crested Newt Presence/Absence Survey Map

DRAWN: Ian Ryding
SCALE: NTS
SURVEY DATES: March-April 2010

PENNINE ecological

1 Moss Cottage, North Road, Bretherton, Lancashire.
01772 600441
ian@pennineecological.co.uk
www.pennineecological.co.uk

Made and published by the Director General of the Ordnance Survey, Chessington, Surrey, 1965.
Reconstituted from former County Series plans and revised 1961.
© Crown Copyright 1965

This page is intentionally left blank

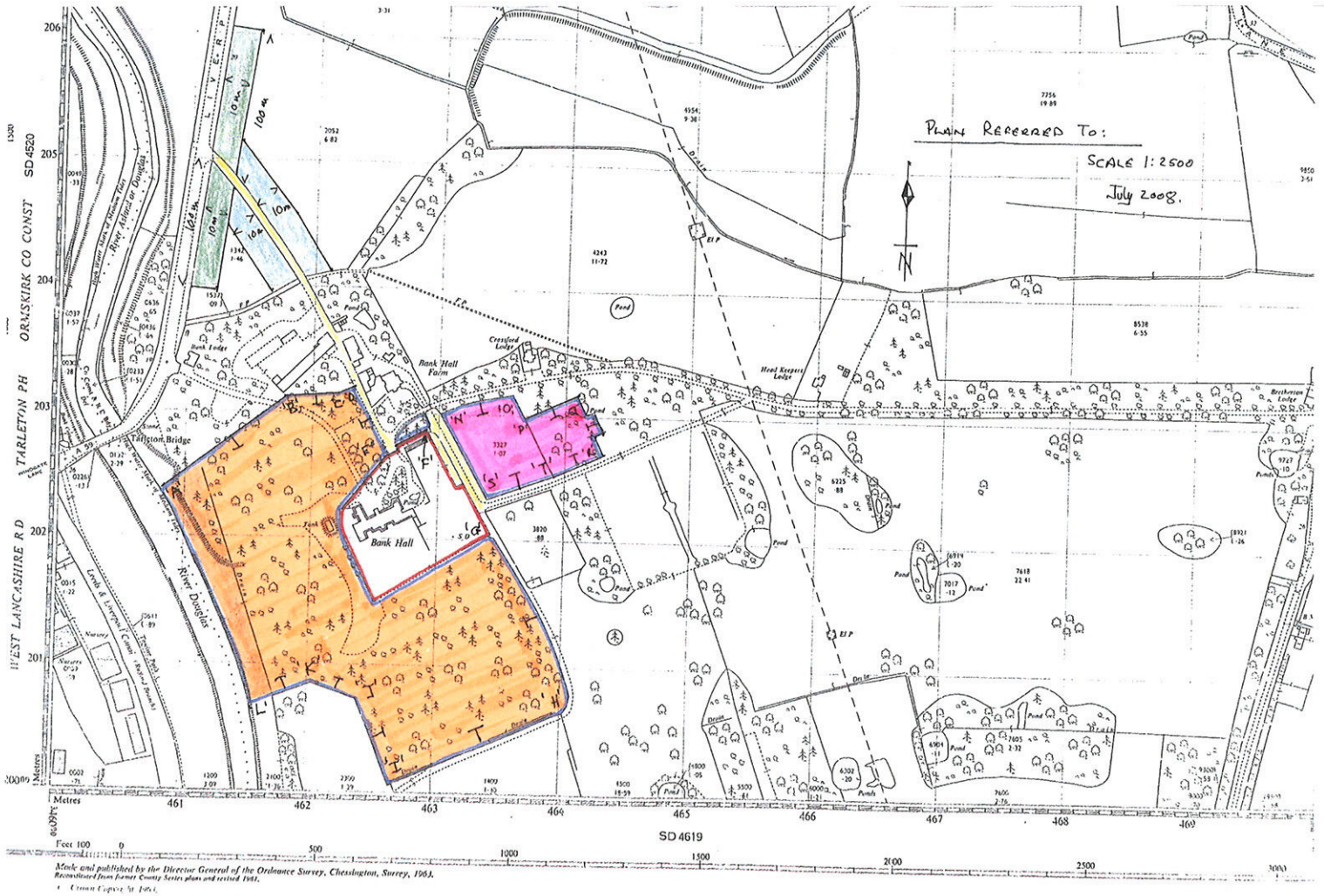

Plans REFERRED TO:
SCALE 1:2500
July 2008.

This page is intentionally left blank

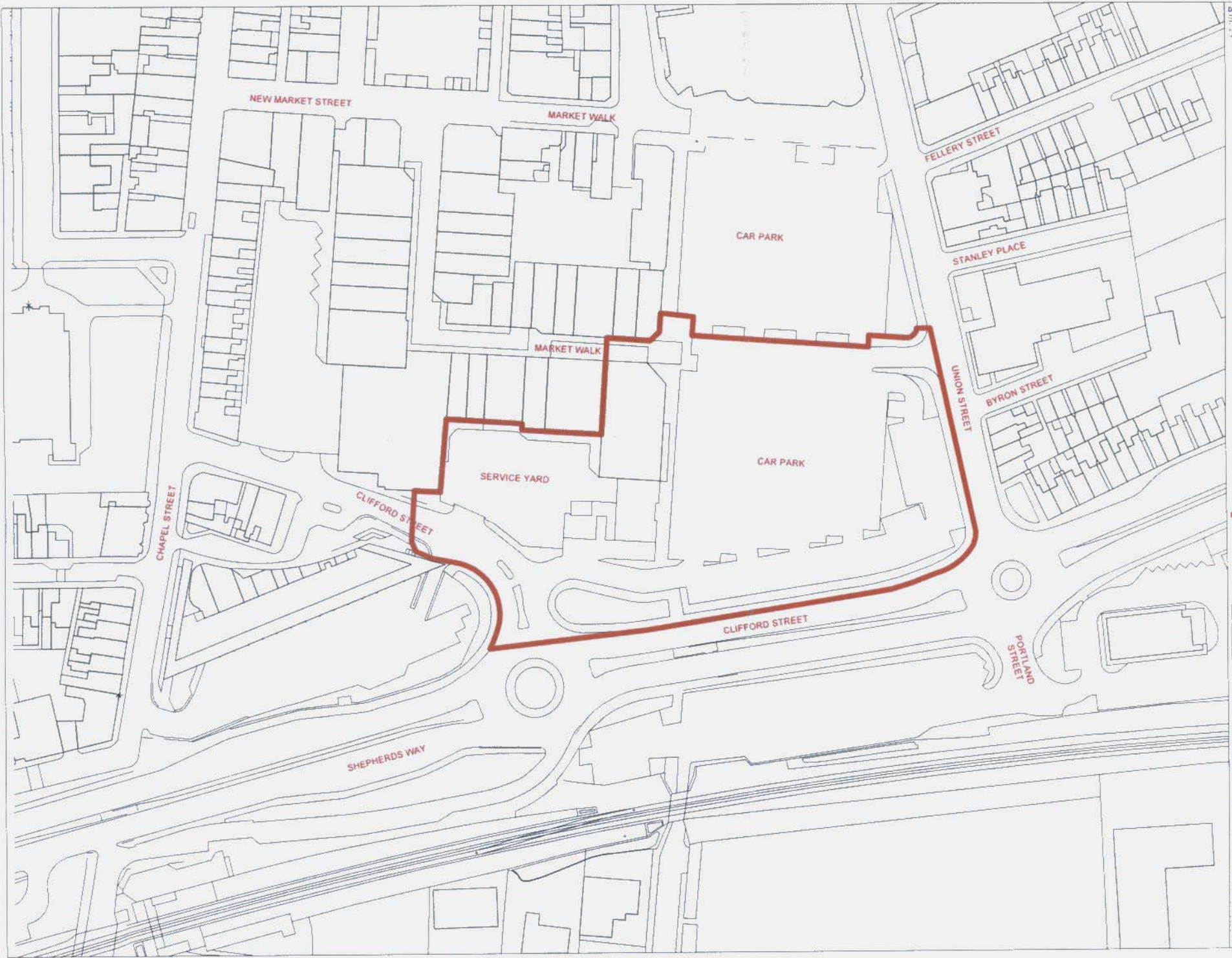

Drawing Record

No.	Description	Date

APPLICATION BOUNDARY

SCALE

PLANNING ISSUE

DO NOT SCALE OFF THIS DRAWING

THIS DRAWING IS A PRELIMINARY DESIGN AND IS NOT TO BE USED FOR CONSTRUCTION OR FOR ANY OTHER PURPOSE WITHOUT THE WRITTEN PERMISSION OF THE ARCHITECT.

ALL RIGHTS RESERVED. NO PART OF THIS DRAWING MAY BE REPRODUCED OR TRANSMITTED IN ANY FORM OR BY ANY MEANS, ELECTRONIC OR MECHANICAL, WITHOUT PERMISSION IN WRITING FROM THE ARCHITECT.

LESLIE JONES

ARCHITECT

MARKET WALK, CHORLEY

PARAMETER PLAN (1)
RED-LINE PLAN

DATE: 10/11/11

SCALE: 1:500

PROJECT: MARKET WALK, CHORLEY

This page is intentionally left blank



For Illustrative Purposes Only

This page is intentionally left blank

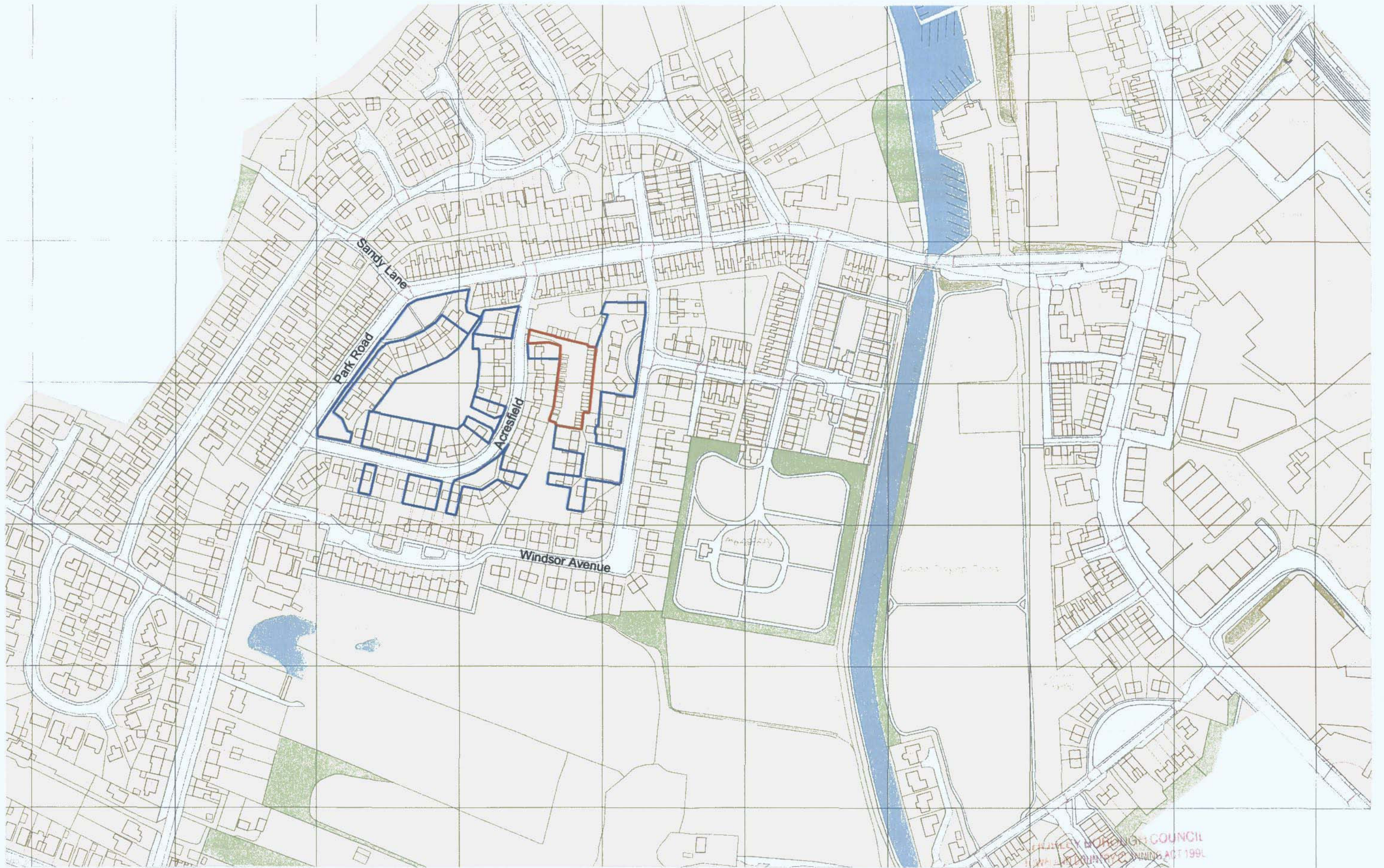

Location Plan @ 1:2500
 P1088 Acresfiled Adlington
 17.06.10

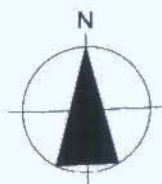

30 AUG 2010

THIS IS THE PLAN REFERRED TO IN
 APPLICATION NO. 17/10/10



Halsall Lloyd Partnership
 ARCHITECTS & DESIGNERS

This page is intentionally left blank

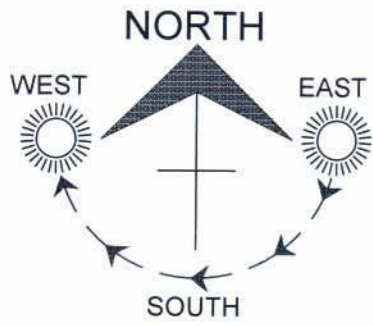

© This drawing and the building works depicted therein are the copyright of Arley Homes NW Ltd and may not be used, copied or amended except by written permission.

CHORLEY BOROUGH COUNCIL
 22 OCT 2010
 THIS IS THE PLAN REFERRED TO IN
 APPLICATION NO. 10 946

REV.	DESCRIPTION	INT.	DATE
------	-------------	------	------



ARLEY HOMES NORTHWEST LTD
 THE OLD RECTORY, RECTORY LANE,
 WINWICK, WARRINGTON, WA2 8LE
 TEL: 01925 851155 FAX: 01925 853333

PROJECT
 DUXBURY WOODS
 MYLES STANDISH WAY
 CHORLEY

DRAWING TITLE
 LOCATION PLAN

JOB NUMBER	502	REV	
DRAWING NUMBER	101		
DRAWN	FDW	SEPT'10	SCALE
CHECKED	FDW		1:2500

This page is intentionally left blank



AMENDED PLAN

CHARLEY DEVELOPMENT CONSULTANTS
 19 JAN 2011 AD
 THIS IS THE PLAN FOR THE APPLICATION NO. 14/00545

NOTE:

- Do not scale from this drawing.
- Any discrepancy to be found in each document (drawing, report, etc.) shall prevail over any other document.
- Discrepancies shall be resolved by the Senior Project Manager.

SCHEDULE OF ACCOMMODATION

NO.	DESCRIPTION	PROPOSED	EXISTING	TOTAL
1	RESIDENTIAL	14	14	28
2	COMMERCIAL	1	1	2
3	PUBLIC	1	1	2
4	INDUSTRIAL	1	1	2
5	RECREATIONAL	1	1	2
6	OTHER	1	1	2
7	TOTAL	19	19	38

GROSS AREA:

NO.	DESCRIPTION	PROPOSED	EXISTING	TOTAL
1	RESIDENTIAL	14	14	28
2	COMMERCIAL	1	1	2
3	PUBLIC	1	1	2
4	INDUSTRIAL	1	1	2
5	RECREATIONAL	1	1	2
6	OTHER	1	1	2
7	TOTAL	19	19	38

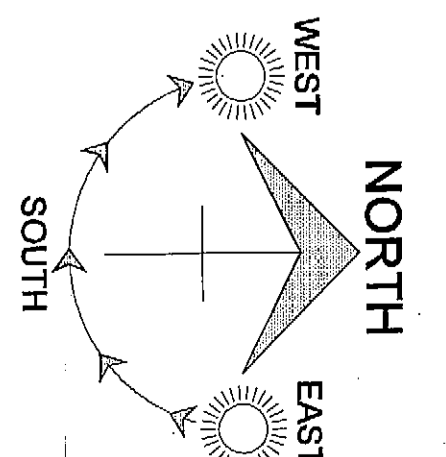

ARLEY HOMES NORTHWEST LTD
 THE OLD RECTORY, RECTORY LANE,
 WIMBORNE, WILTSHIRE, WILTSHIRE, WILTSHIRE
 TEL: 01985 841133 FAX: 01985 841133

PROJECT: DUXBURY PARK
 MILES STANDISH WAY
 CHORLEY

DRAWING TITLE:
 PLANNING LAYOUT

NO.	DATE	BY	FOR
1	19 JAN 2011	AD	AD

NO.	DATE	BY	FOR
1	19 JAN 2011	AD	AD

This page is intentionally left blank

Copyright

The copyright of this drawing is held by Croft Goode Limited, and no reproduction is allowed without prior permission.

Notes

This drawing must be checked and verified by the contractor prior to work commencing on site. Liability shall not be taken for any defects in this drawing unless, prior to commencing, this drawing and all its dimensions have been so checked and verified. All dimensions are in millimetres. Do not scale.

Key:

Site Boundary —



10/01067



project
Park Hall
South Hall
Charnock Richard, Chorley PR7 5LP

client
Help the Homeless Chorley Ltd

drawing title
Site Location Plan

status
Planning

drawing no. revision scale drawn by date
10-1631 LO1 - 1:1000@ A3 GLB Nov 10



Croft Goode Chartered Architects 41 The Crossroads, Freckleton Street, Kirkham, Lancashire PR4 2SH
t 01772 686 030 e mail@croftgoode.co.uk
f 01772 686 050 www.croftgoode.co.uk

Park Hall
(Hotel, Leisure and
Conference Centre)

Car Park

Sports Centre

TCB

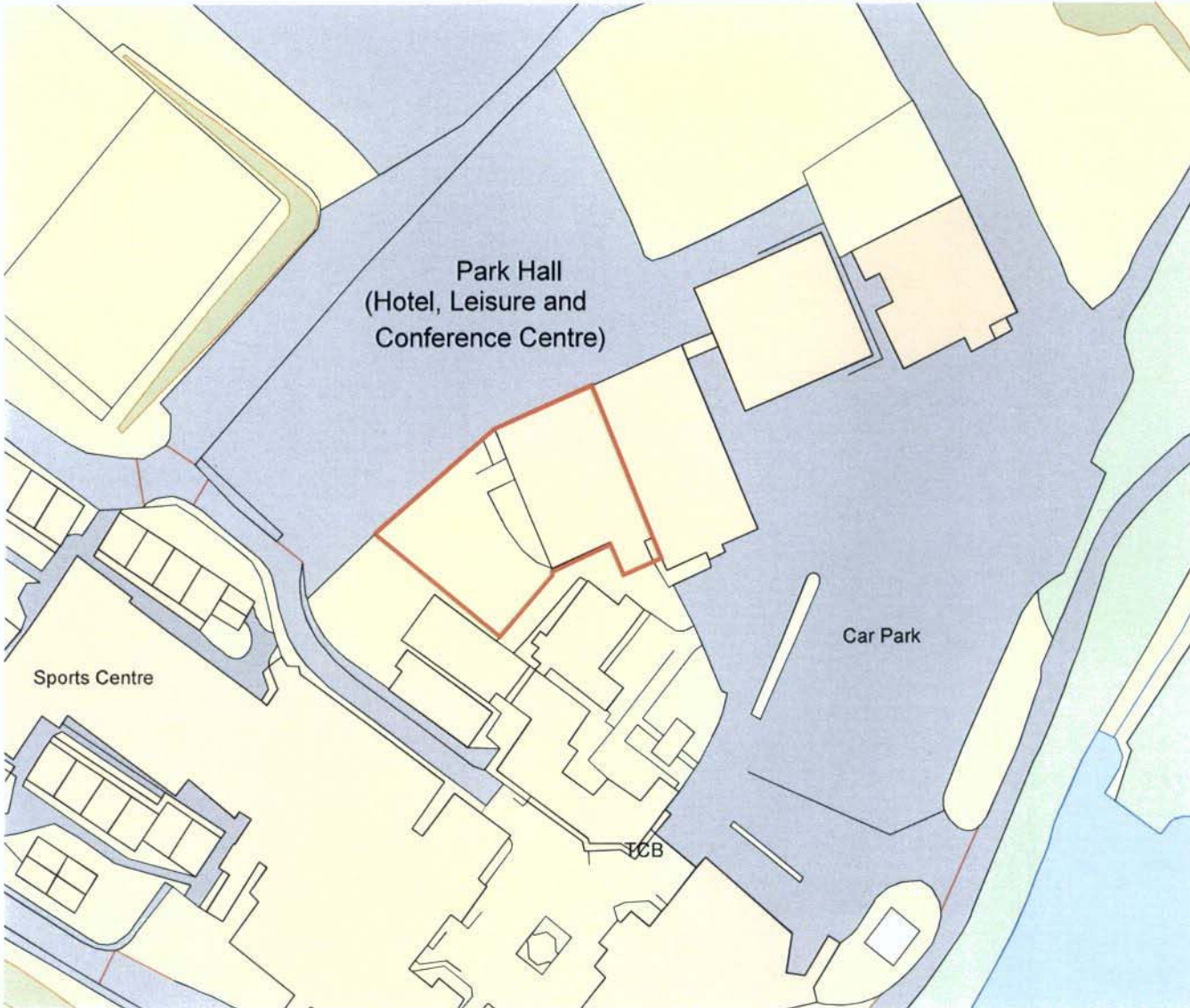

This page is intentionally left blank

Site Survey



OS Sitemap®



Produced 16.06.2009 from the Ordnance Survey National Geographic Database and incorporating surveyed revision available at this date. © Crown Copyright 2009.

Reproduction in whole or part is prohibited without the prior permission of Ordnance Survey.

Ordnance Survey, the OS Symbol and OS Sitemap are registered trademarks of Ordnance Survey, the national mapping agency of Great Britain.

The representation of a road, track or path is no evidence of a right of way.

The representation of features as lines is no evidence of a property boundary.

Part or all of this OS Sitemap is enlarged from mapping produced at one or more of the following scales: 1:1250, 1:2500, 1:10000.

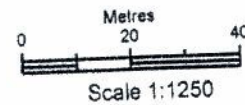

Supplied by: Chorley B C
Serial number: 08400100
Centre coordinates: 363008.25 412009.25

Further information can be found on the OS Sitemap information leaflet or the Ordnance Survey web site: www.ordnancesurvey.co.uk

Previously Developed Land

-  Footprint of Existing Building
-  Car Park / Access / Hardstanding
-  Play Area
-  Garden Area

Area

- 500m²
- 3300m²
- 1350m²
- 1050m²

Client
THE SQUIRREL SITE DEVELOPMENT

Title
SITE SURVEY

Drawing No.
10W116-001

Revision/Issue
C

Scale & Sheet Size
1:300 @ A1

Drawn by
AWJ

Whitespace Consultants Ltd.

Nortex Business Centre,
105 Chorley Old Road, Bolton,
BL1 3AS
T. 01204 599800 F. 0870 7621631
Web www.whitespace.org.uk

CHORLEY BOROUGH COUNCIL
TOWN AND COUNTRY PLANNING ACT 1990

16 DEC 2010

THIS IS THE PLAN REFERRED TO IN
APPLICATION NO 10/1095

Location Plan

THIS DRAWING/DESIGN IS THE SOLE COPYRIGHT OF V...
AND MAY NOT BE REPRODUCED IN ANY FORM WITHOUT...
THIS DRAWING IS ALSO AVAILABLE ON DISKETTE OR B...
PLEASE CONTACT THE ABOVE OFFICE ON 01204 599800

issue*0" indicates for information and draft purposes only.

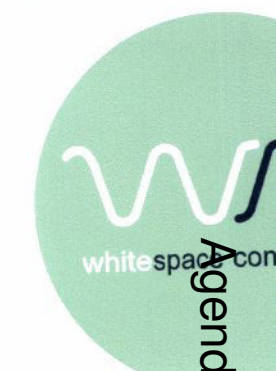

This page is intentionally left blank

an environment
to make your competitors
green
with envy

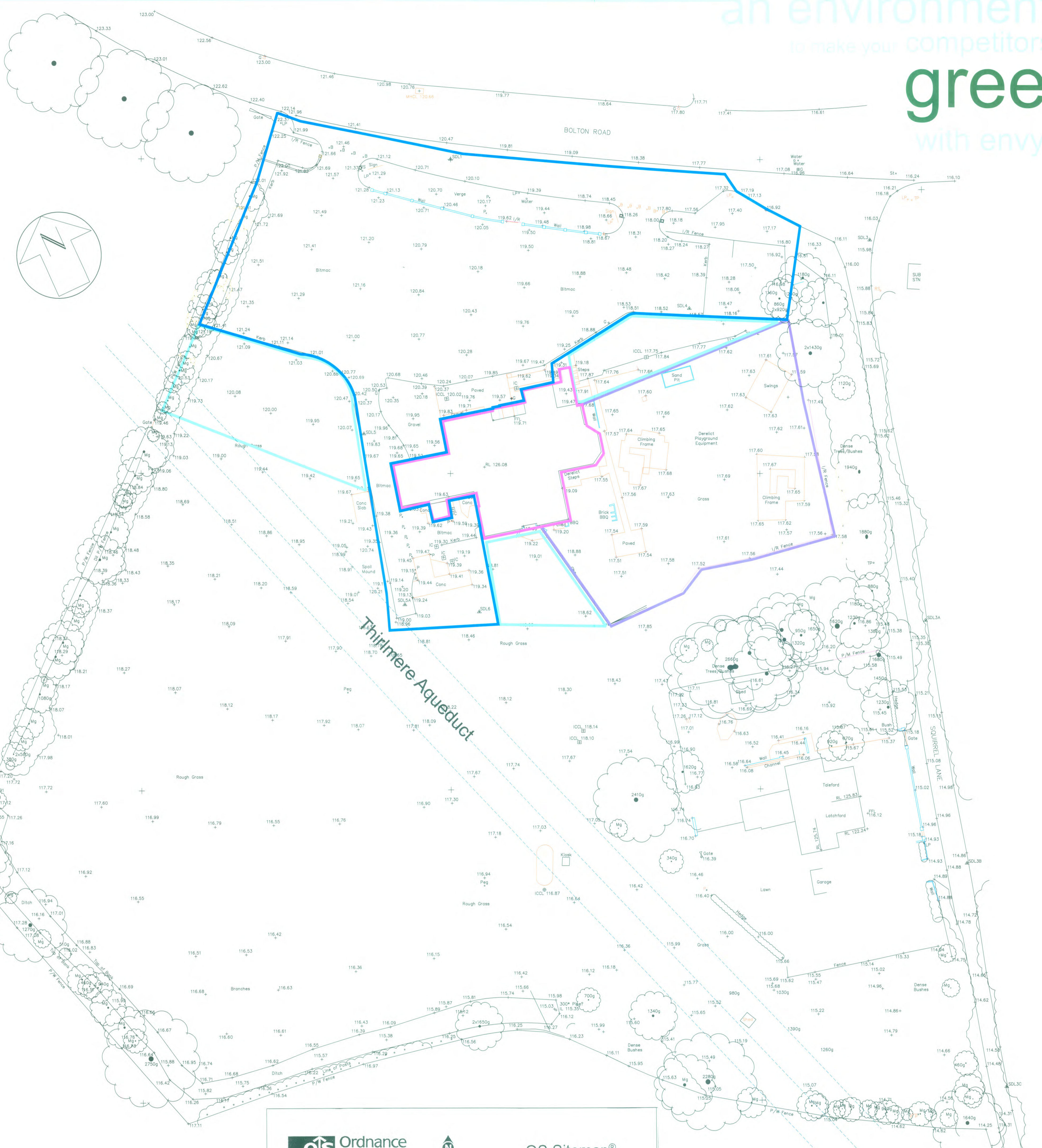

Existing Site Survey

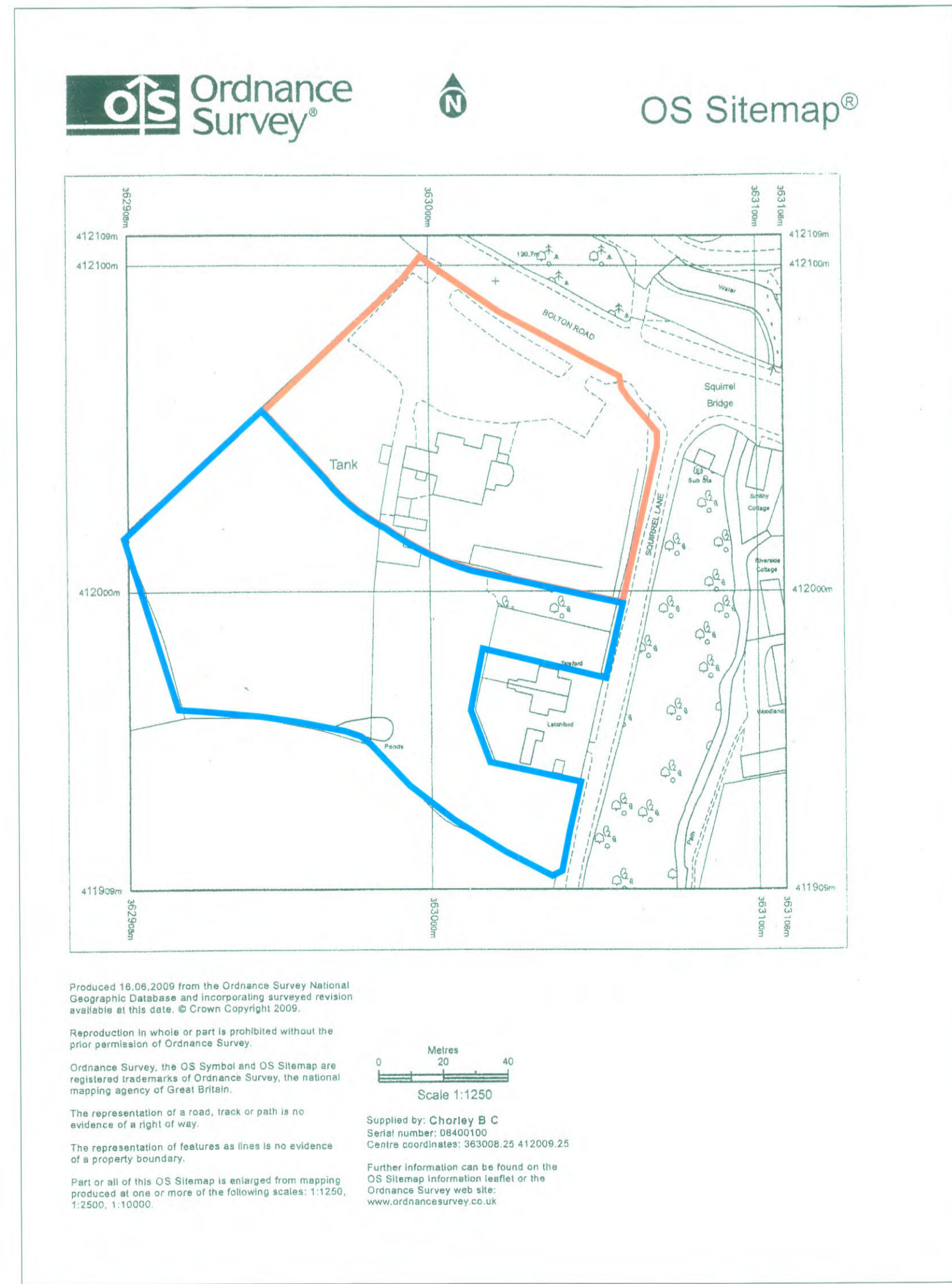

Previously Developed Land	Area
 Footprint of Existing Building	500m ²
 Car Park / Access / Hardstanding	3300m ²
 Play Area	1350m ²
 Garden Area	1050m ²

Client
THE SQUIRREL SITE DEVELOPMENT

Title
SITE SURVEY

Drawing No. 10W116-001	Revision/Issue no. C	Date 13/12/10
Scale & Sheet Size 1:300 @ A1	Drawn by AWJ	Approved by NY

Whitespace Consultants Ltd.
Nortex Business Centre,
105 Chorley Old Road, Bolton,
BL1 3AS
T. 01204 599800 F. 0870 7621631 E. sales@whitespace.org.uk
Web www.whitespace.org.uk

15 DEC 2010

10295



Location Plan

THIS DRAWING/DESIGN IS THE SOLE COPYRIGHT OF WHITESPACE CONSULTANTS LIMITED AND MAY NOT BE REPRODUCED IN ANY FORM WITHOUT PRIOR CONSENT. THIS DRAWING IS ALSO AVAILABLE ON DISKETTE OR BY EMAIL. PLEASE CONTACT THE ABOVE OFFICE ON 01204 599800 FOR FURTHER DETAILS.

Issue '0' indicates for information and draft purposes only.

This page is intentionally left blank

Buckshaw Village Green Corridor

WARNING TO HOUSE PURCHASERS
Property Misdescriptions Act 1991

Buyers are warned that this is a working drawing and is not intended to be treated as an accurate matter of description in relation to any particular property or development, any of the specified matters provided by any Order made under the above act. The contents of this drawing may be subject to change at any time, and alterations and variations can occur during the progress of the works without revision of the drawing. Consequently the layout, form, content and dimensions of the finished construction may differ materially from those shown. Nor do the contents of this drawing constitute a contract, part of any contract, or warranty.

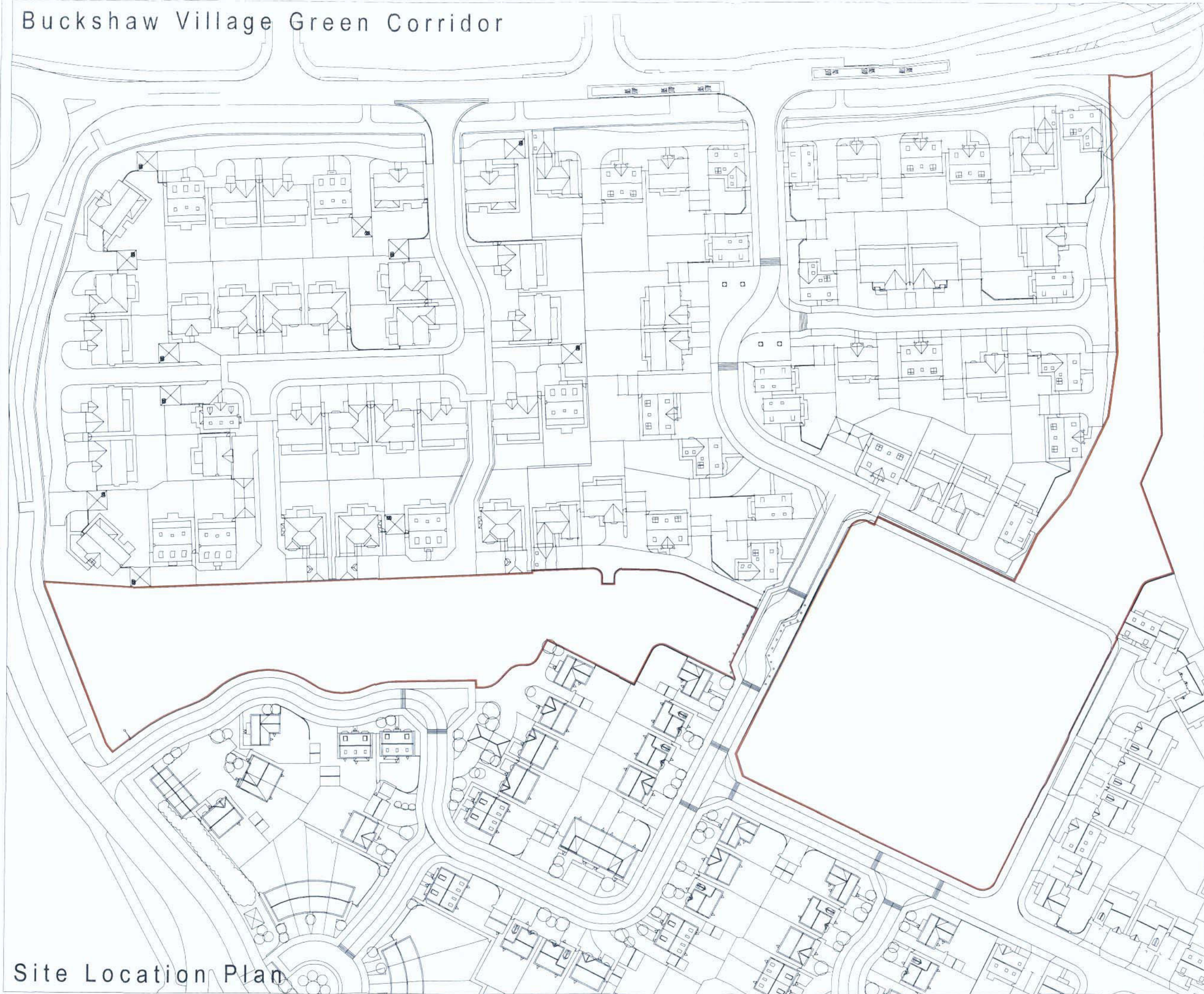

CHORLEY BOROUGH COUNCIL
TOWN AND COUNTRY PLANNING ACT 1990

15 NOV 2013

THIS IS THE PLAN REFERRED TO IN
APPLICATION NO. 10/1012

Rev	Description	Date	Drawn	Chk'd



**BARRATT
HOMES
MANCHESTER**

Barratt Homes Manchester
(A division of BDW Trading Ltd)
4 Brindley Road
City Park
Manchester
M16 9HQ
Tel: 0161 872 0161
Fax: 0161 855 2828

Job:
Buckshaw Village Green Corridor

Title:
Site Location Plan

Design By	Date	Drawing Number	Rev
S.J.W	08.11.2010	412/SL01	
Drawn By	Scale @ A3		
S.J.W	1:1000		

Site Location Plan

This page is intentionally left blank